

## AXLE U-BOLT TIE PLATES

PART #	STYLE	TUBE DIAMETER	SPRING WIDTH	BOLT SIZE
12-R100-TP	A	1.75"	1.75"	.50"
12-R100-TP2	A	1.75"	1.75"	.38"
12-1179594	A	2.00" SQ	2"	.50"
12-R200-TP	B	2.38"	1.75"	.50"
12-012-004	B	2.38"	2.00"	.50"
12-012-001	B	3.00"	1.75"	.50"
12-R300-TP	B	3.00"	2.00"	.50"
12-012-037	B	3.50"	2.00"	.56"
12-012-042	C	4.00"	2.00"	.63"
12-012-049	B	5.00"	2.50"	.63"
12-012-046	C	5.00"	3.00"	.75"
12-012-053	C	5.00"	3.00"	.63"



## AXLE U-BOLT KITS



*\*Kit includes 2 Tie Plates & 4 U-Bolts w/Nuts*

PART #	DESCRIPTION
12-K1	U-Bolt Kit: Fits 1-3/4" Tube, 1-3/4" Wide Spring & 3/8" Diameter U-Bolt
12-K112	U-Bolt Kit: Fits 1-3/4" Tube, 1-3/4" Wide Spring & 1/2" Diameter U-Bolt
12-K2	U-Bolt Kit: Fits 2-3/8" Tube, 1-3/4" Wide Spring & 1/2" Diameter U-Bolt
12-K3	U-Bolt Kit: Fits 3" Tube, 2" Wide Spring & 1/2" Diameter U-Bolt
12-K4	U-Bolt Kit: Fits 3" Tube, 1-3/4" Wide Spring & 1/2" Diameter U-Bolt

# AXLE U-BOLTS-ROUND

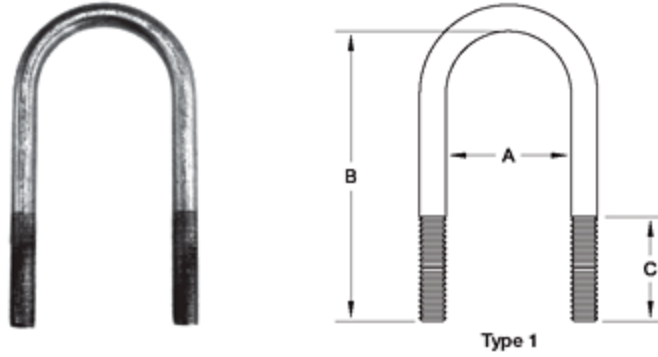

PART #	FITS TUBE DIAMETER	THREAD SIZE	DIMENSIONS		
			A	B	C
12-011-054	1.75"	3/8"-24	1.81"	4.29"	2.00"
12-R100-UB	1.75"	1/2"-20	1.81"	4.29"	2.00"
12-854-8208	1.75"	1/2"-20	1.81"	4.88"	2.00"
12-011-075	2.38"	7/16"-20	2.44"	5.13"	2.00"
12-R200-UB	2.38"	1/2"-20	2.44"	5.50"	2.00"
12-011-022	2.38"	1/2"-20	2.44"	6.25"	3.00"
12-011-049	3.00"	1/2"-20	3.00"	5.50"	2.00"
12-R300-UB	3.00"	1/2"-20	3.09"	6.50"	2.00"
12-73260	3.00"	1/2"-20	3.09"	7.00"	2.00"
12-300700-5	3.00"	9/16"-18	3.09"	7.00"	3.00"
12-011-065	3.50"	9/16"-18	3.56"	8.00"	2.00"
12-011-064	4.00"	5/8"	4.09"	8.50"	2.00"
12-011-077	5.00"	5/8"	5.06"	9.00"	2.00"
12-011-070	5.00"	3/4"	5.06"	9.31"	1.75"

# U-BOLTS-SQUARE

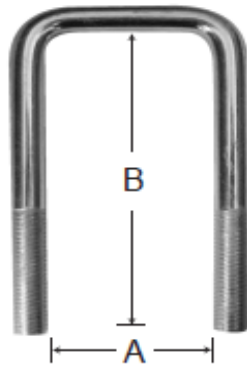

PART #	FITS TUBE WIDTH	THREAD SIZE	DIMENSIONS	
			A	B
12-854-8217	1.75" SQ	1/2"-20	1.75"	4.5"
12-7158	2" SQ.	3/8"-16	2-1/16"	3"
12-7163	2" SQ.	3/8"-16	2-1/8"	2-1/2"
12-7164	2" SQ.	3/8"-16	2-1/8"	3-1/2"
12-7165	2" SQ	3/8"-16	2-1/8"	4"
12-7166	2" SQ.	3/8"-16	2-1/8"	5"
12-7167	2" SQ.	3/8"-16	2-1/8"	6"
12-7172	2" SQ.	3/8"-16	2-1/8"	5-1/2"
12-7174	3" SQ.	3/8"-16	3-1/8"	2-1/2"
12-7175	3" SQ.	3/8"-16	3-1/8"	3"
12-7178	3" SQ.	3/8"-16	3-1/8"	5"
12-7180	4" SQ.	3/8"-16	4-1/8"	3"
12-7181	4" SQ.	3/8"-16	4-1/8"	4"
12-9146	2" SQ.	1/2"-13	2-1/8"	4-1/2"
12-9154	2" SQ.	1/2"-13	2-1/8"	4"
12-9156	2" SQ.	1/2"-13	2-1/8"	5"
12-9157	2" SQ.	1/2"-13	2-1/8"	6"
12-9159	2" SQ.	1/2"-13	2-1/8"	7"
12-011-066	2" SQ.	1/2"-13	2-1/8"	7"
12-9164	3" SQ.	1/2"-13	3-1/8"	4"
12-9165	3" SQ.	1/2"-13	3-1/8"	5"
12-9166	3" SQ.	1/2"-13	3-1/8"	6"
12-9169	3" SQ.	1/2"-13	3-1/8"	7"
12-9148	3" SQ.	1/2"-13	3-1/8"	8"

## SPRINGS: DOUBLE EYE

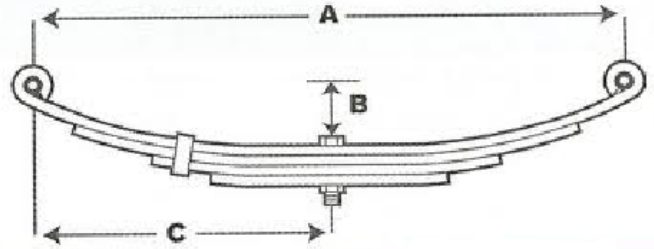

*\*Use 9/16" Spring Bolts*

PART#	NUMBER OF LEAVES	FREE LENGTH A	FREE ARCH B	CAPACITY (POUNDS)	REFERENCE NUMBER
10-169	3	20.38"	3.18"	1,000	DE-7217
10-167	4	20.5"	3.38"	1,400	DE-7213
10-216	3	23.13"	3.50"	1,750	DE-729
10-222	6	24.88"	3.38"	3,500	DE-7227
10-219	3	25.25"	3.18"	1,250	DE-7222
10-212	4	25.25"	3.00"	1,750	DE-7242
10-220	3	25.25"	3.00"	2,000	DE-7224
10-218	4	25.25"	3.00"	2,500	DE-SW4, 72-25
10-111	5	25.25"	3.00"	2,900	DE-1764
10-72-40	1	25.25"	3.00"	3,000	72-40
10-124	4	26"	4.12"	1,000	DE-261000
10-050	3	26"	4.25"	1,500	DE-AWS3
10-051	4	26"	4.25"	2,000	DE-AWS4
10-052	5	26"	4.25"	2,500	DE-AWS5
10-210	4	27"	2.88"	2,100	DE-33613
10-142	6	27"	3.25"	3,000	DE-33617

## SPRINGS: HOOK-END SLIPPER (HOOK-END)

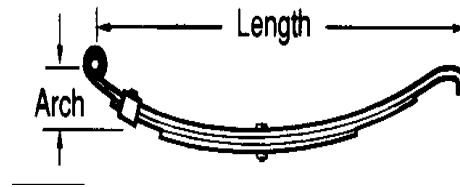

PART#	SPRING WIDTH	NUMBER OF LEAVES	FREE LENGTH	FREE ARCH	CAPACITY (POUNDS)	EYE DIAMETER	REFERENCE NUMBER
10-803T3	2"	4	26.175"	3.00"	2,000	9/16" Nylon	UNA-230
10-231	2"	4	26.50"	3.06"	2,500	9/16" Nylon	100-3T3
10-232	2"	5	26.50"	3.18"	3,500	9/16" Nylon	120-3T3
10-233	2"	7	26.50"	3.00"	4,000	9/16" Nylon	140-3T3
10-E5226	2"	5	26.625"	3.5"	3,000	9/16" Nylon	UNA-160
10-E5115	2"	6	29.5"	3.5"	4,000	9/16" Nylon	UNA-161

## SPRINGS: HOOK-END SLIPPER (FLAT-END)



PART#	SPRING WIDTH	NUMBER OF LEAVES	FREE LENGTH	FREE ARCH	CAPACITY (POUNDS)	EYE DIAMETER	REFERENCE NUMBER
10-WIC2	1-3/4"	2	24.25"	4.00"	500	9/16" Nylon	n/a
10-WIC3	1-3/4"	3	24.25"	4.00"	750	9/16" Nylon	n/a
10-039	1-3/4"	3	30.00"	4.88"	1,500	9/16" Nylon	UNA-039, WF-3
10-040	1-3/4"	4	30.00"	4.88"	2,000	9/16" Nylon	UNA-040, WF-4
10-72-10-2	2"	6	30.00"	2.00"	4,500	5/8" Rubber	72-10-2
10-72-77	2-1/2"	5	30.00"	4.00"	5,000	7/8" Bronze	72-77
10-72-21	2-1/2"	5	30.00"	2.50"	5,000	3/4" Rubber	72-21
10-93161	2-1/2"	5	32.50"	n/a	5,000	3/4" Rubber	93161
10-72-43	3"	5	30.00"	3.00"	5,000	1" Rubber	72-43
10-72-44	3"	6	30.00"	3.00"	6,000	1" Rubber	72-44

# BUSHINGS

PART #	DESCRIPTION			TYPE	REF #	STYLE
	ID	OD	LENGTH			
10-9224	.50"	.875"	1.75"	Nylon	BU1-1508	A
10-9225	.5625"	.875"	1.75"	Nylon	BU1-1568	A
10-9229	.5625"	.6875"	2.00"	Nylon	BU1-2566	A
10-9536	.50"	.6875"	1.75"	Nylon	BU1-1506	A
10-9910-SB	.5625"	1.31"	2.00"	Nylon	14-54-1	D
10-9912-SB	.5625"	.6875"	1.75"	Nylon	BU1-1566	A
10-9914	.5625"	.6875"	1.75"	Bronze	14-77	B
10-91413	.75"	1.75"	2.75"	Rubber/ Steel	91413	C
10-91414	1.00"	2.125"	4.00"	Rubber/ Steel	91414	C
10-EQ-12	.89"	1.08"	2.84"	Nylon	Fits 4541 EQ	A
28-014-067	.75"	1.0"	2.5"	Bronze	14-67	B
28-014-069	1.00"	2.06"	3.12"	Rubber/ Steel	14-69	C
28-014-070	1.12"	2.12"	3.75"	Rubber/ Steel	14-70	C
28-014-073-01	.646"	1.375"	2.18"	Rubber/ Steel	14-73-1	E
28-014-074	1.0"	2.11"	3.12"	Rubber/ Steel	14-74	C

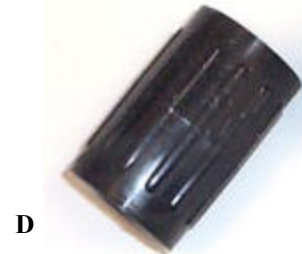

# SUSPENSION BOLTS

PART #	REF. #	SIZE	LENGTH	GRADE	DESCRIPTION	STYLE
40-38-3	7-7	5/16"-18	3 1/4"	2	Spring Retainer Bolt	B
28-007-095	7-95	1/2"-20	4 1/2"	2	10K, 12K, 15K Spring Retainer Bolt	B
40-21001	9163B	9/16"-18	3"	5	Double Eye Shackle Bolt, Plain Finish	C
40-007-187	7-187	9/16"-18	3"	5	Double Eye Shackle Bolt w/ Grease Zerk	D
40-007-236-01	7-236-1	9/16"-18	3 1/2"	5	Double Eye Shackle Bolt w/ Grease Zerk	D
40-21005	91635B	9/16"-18	3 1/2"	5	Slipper Spring Shackle Bolt	C
28-007-181	7-181	5/8"-11	4"	5	9K Spring Eye Bolt	F
28-007-264	7-264	3/4"-10	4 1/2"	5	10GD Rubber Bushed Spring Eye Bolt	F
28-007-135-2	7-135-2	3/4"-10	4 1/2"	5	10K GD Spring Eye Bolt w/ Grease Zerk	A
29-090747	090747	3/4"-16	4 1/2"	5	10K 12K Hayes Spring Eye Bolt	F
40-24014	7-1-1	7/8"-9	4 5/8"	2	Equalizer Center Bolt w/ Grease Zerk	E
28-007-182	7-182	1"-8	5"	5	9K Equalizer Center Bolt	E
28-007-260	7-260-2	7/8"-9	4 1/2"	2	10K GD Spring Eye Bolt w/ Grease Zerk	A
28-007-169	7-169	1"-8	5 1/2"	5	10K, 12K, 15K Dexter Spring Eye Bolt	F
28-007-136-2	7-136-2	1"-8	5 1/4"	5	10K GD Equalizer Center Bolt w/ Grease Zerk	E
29-090746	090746	1"-14	5 7/8"	5	10K, 12K Hayes Equalizer Center Bolt	E
28-007-170	7-170	1 1/8"-7	6"	5	10K, 12K, 15K Dexter Equalizer Center Bolt	F

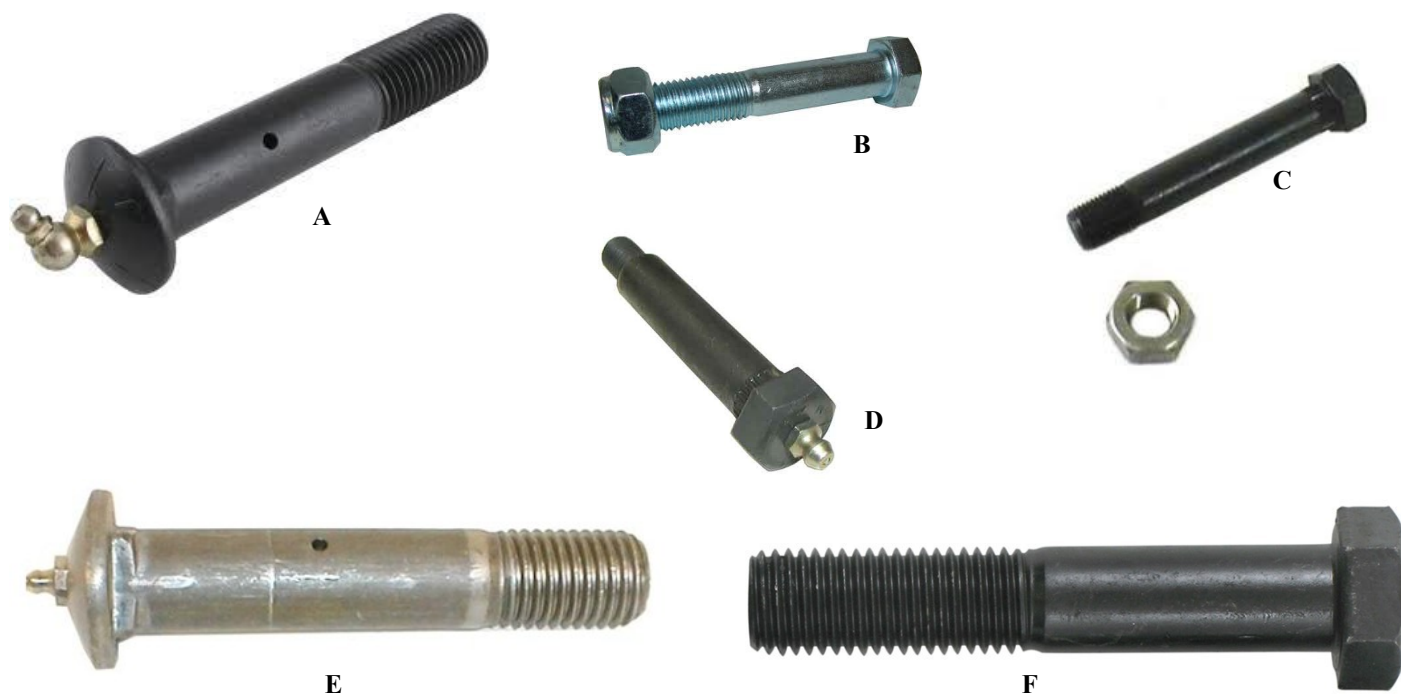

# CAST EQUALIZERS

All cast equalizers are manufactured from ductile iron. Equalizers are manufactured to industry standards and come finished in black paint.

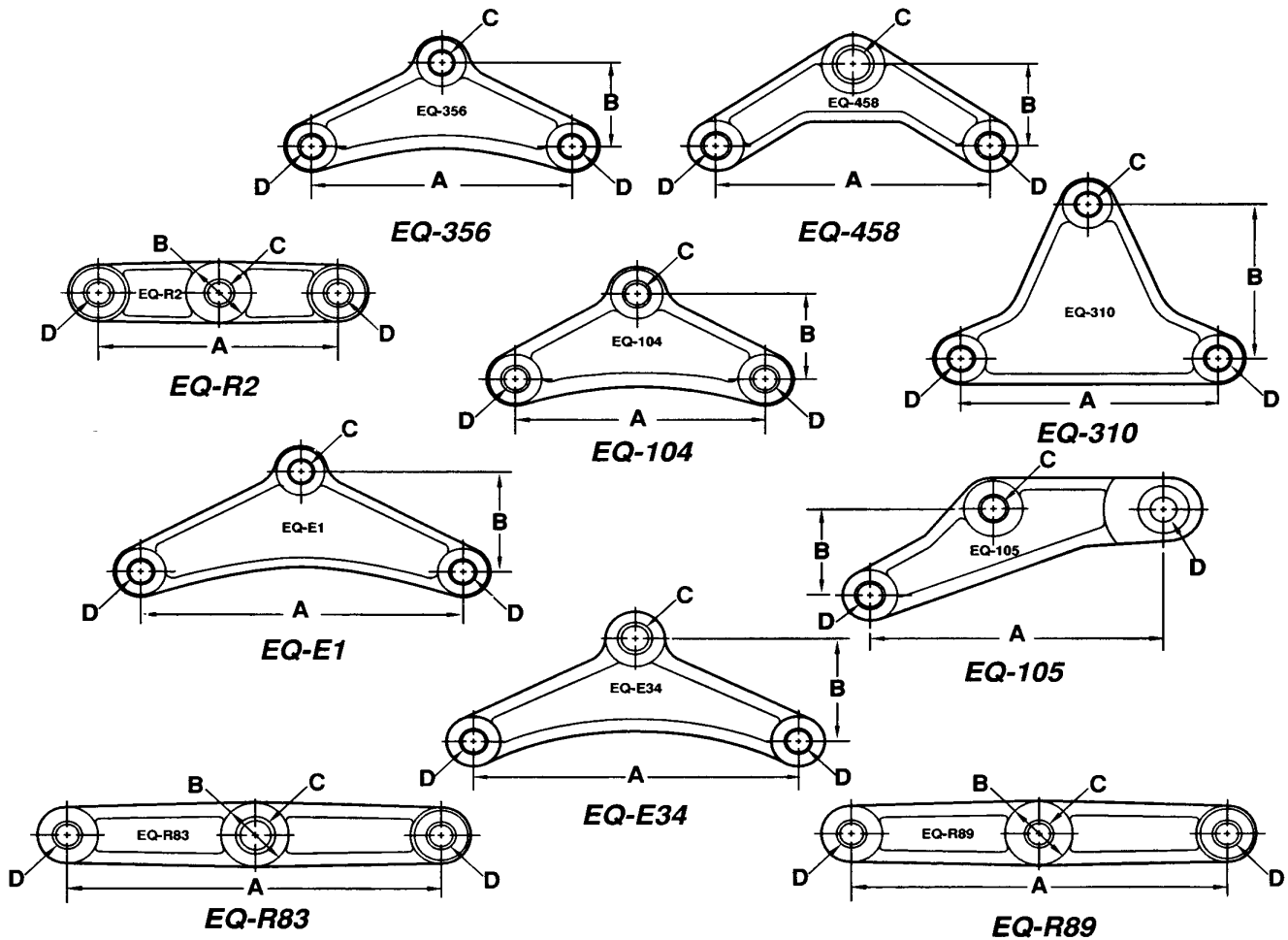

PART #	REFERENCE #	A	B	C	D
14-13-9	EQ-310	5 ½"	1 ½"	9/16"	9/16"
14-R2	EQ-R2	6 1/16"	4"	9/16"	9/16"
14-104	EQ-104	5 ¾"	2"	9/16"	9/16"
14-091356	EQ-356	6 1/8"	2 ½"	9/16"	9/16"
14-09138604	EQ-458	6 ¼"	2"	3/4"	9/16"
14-EQ-105	EQ-105	6 ¾"	2"	9/16"	9/16"
14-091301	EQ-E1	7 ¾"	2 7/8"	9/16"	9/16"
14-EQ-34	EQ-E34	7 ¾"	2 7/8"	3/4"	9/16"
14-R83	EQ-R83	8"	1 ¾"	3/4"	9/16"
14-R89	EQ-R89	8"	1 ¾"	9/16"	9/16"



# STEEL FABRICATED EQUALIZERS

The following steel fabricated equalizers are designed for the use of 2" wide slipper springs in a tandem or triple axle application. The equalizers are made to industry standards.

EQ-1304, EQ-1344, EQ-4541

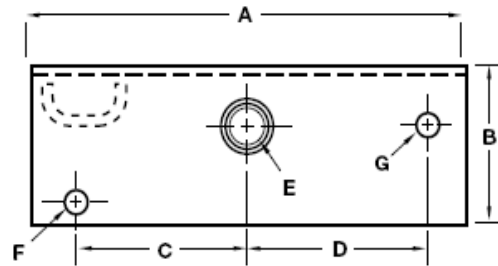

EQ-1354

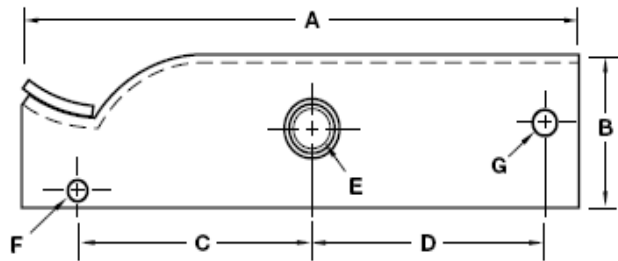
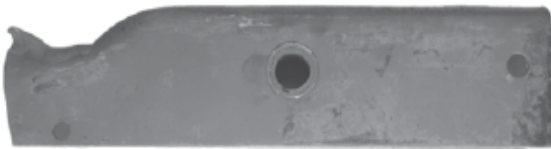

PART #	A	B	C	D	E	F	G	Style
14-EQ-1304	11"	3.50"	5.19"	4.63"	.88"	.44"	.56"	1
14-EQ-4541	12"	4"	4.44"	4.75"	.88"	.56"	.56"	1
14-EQ-1344	13"	3.50"	5.94"	5.50"	.88"	.44"	.56"	1
14-EQ-1354	13.88"	3.50"	5.88"	5.75"	.88"	.38"	.56"	2

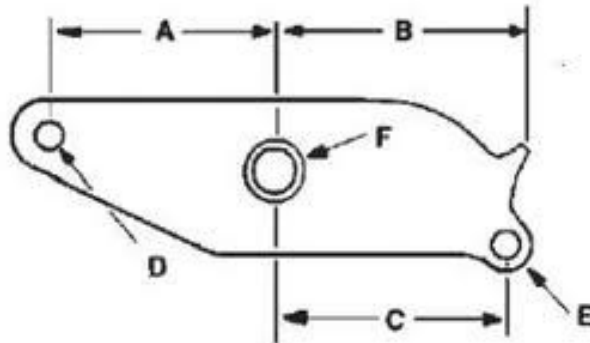

PART #	DESCRIPTION	A	B	C	D	E	F
14-13-4	EQ for 2" slipper spring	4-3/4"	5-1/2"	5"	9/16"	3/8"	7/8"

# SHACKLE LINKS

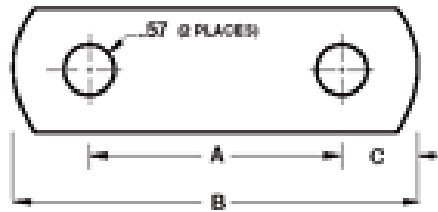

OLD PART # AJAX	NEW PART # AJAX	DIMENSIONS		REF. #	ID #
		A	D		
13-100	13-200	2.00"	0.22"	18-11	10
13-101	13-225	2.25"	0.22"	115841D	11
13-102	13-256	2.56"	0.22"	18-115	15
13-106	13-275	2.75"	0.22"	N/A	N/A
13-103	13-313	3.13"	0.22"	18-12	12
13-104	13-350	3.50"	0.22"	18-3.5	13
13-018-624	13-018-624	2.25"	0.50"	18-24-1	N/A
13-018-022-01	13-018-022-01	3.12"	0.50"	18-22-1	N/A

## SPRING HANGERS – 1 3/4” WIDE SPRINGS

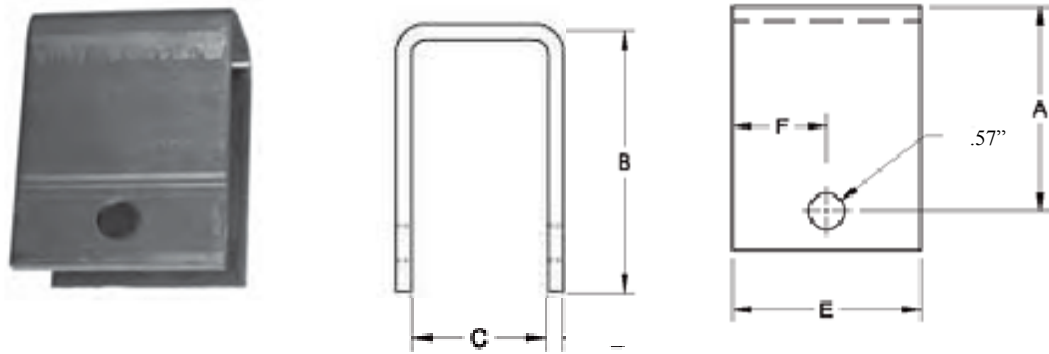

PART #	A	B	C	D	E	F	REFERENCE NUMBER
15-HG144	1.44"	2.06"	1.88"	.23"	3.00"	1.50"	28-6
15-HG200	2.00"	2.63"	1.88"	.23"	3.00"	1.50"	29-8
15-HG246	2.46"	3.09"	1.88"	.23"	3.00"	1.50"	28-3
15-HG325	3.25"	3.87"	1.88"	.23"	3.00"	1.50"	28-5
15-HG350	3.50"	4.12"	1.88"	.23"	3.00"	1.50"	N/A
15-HG362	3.62"	4.24"	1.88"	.23"	3.00"	1.50"	29-31
15-HG425	4.25"	4.87"	1.88"	.23"	3.00"	1.50"	28-4

## REAR SPRING HANGERS – 1 3/4” DOUBLE EYE SPRINGS



PART #	TOP TO HOLE CENTER	WIDTH OF HANGER	LENGTH OF HANGER	STYLE
15-H100	1.18"	1.75"	1.50"	A
15-HG101	1.18"	1.75"	1.50"	B
15-H93003X	1.18"	1.75"	3.00"	C

## 2" WIDE SLIPPER SUSPENSION HANGERS

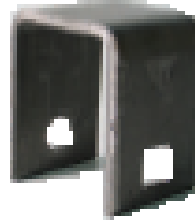
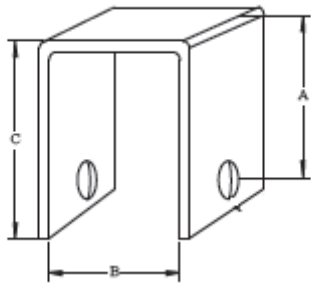

PART #	A	B	C	DESCRIPTION	REFERENCE NUMBER
15-092820	3.75"	2.25"	4.50"	Front Hanger	n/a
15-092825	4.00"	2.25"	5.00"	Front Hanger	H-5
15-HG281F	4.25"	2.25"	4.88"	Front Hanger	28-1
15-092910	4.25"	3.00"	5.20"	Center Hanger	H-5.2 SQ
15-029-001	3.50"	3.00"	4.50"	Center Hanger	29-1
15-093023	5.00"	2.25"	6.00"	Rear Hanger (3 1/2" to Ride Plate)	H-6-R
15-030-028	5.38"	2.25"	6.00"	Rear Hanger (4" to Ride Plate)	30-28